



Weight hopper



Weight hopper

The weight hopper is a fruit weighing machine for the fruit that is removed from the packing line such as rejects and under or over size.

It is equipped with a tilting chute for bin filling and can be connected electronically with the sizer, to deduct the kilos that pass through the hopper from the total production in an automated way.

FEATURES & BENEFITS

- The weighing hopper allows us to control the total fruit weight that passed through it and can be deducted from the total produced in an automated way.
- Powered by a conveyor belt, the hopper is filled to the predetermined weight (5 Kg). When this weight is reached, the hopper is discharged.
- Highest quality standards to ensure long durability.



Weighing hopper entry

KEY SPECIFICATIONS

- Designed to comply with the Machine Directive of the European Union (CE) 2006/42/CE
- Capacity: 5 Kg weight discharges

TECHNICAL INFORMATION

- Power: 3 phases - 380 V - 50 Hz
- Air consumption: 0,125 l/min per 5 Kg weight discharge

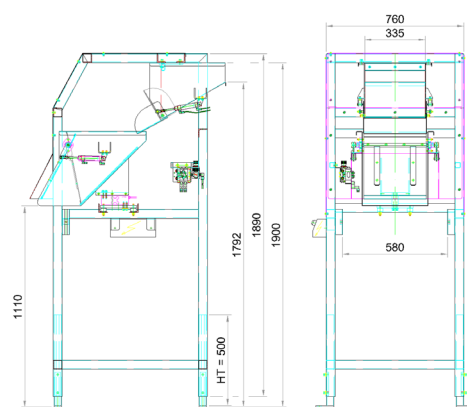

Plant view and side view of the weighing hopper