



6 boxes depalletizer & tipper

The full 6 crates layer depalletizer is designed to depalletize by layer on a chain table, which distributes the boxes in groups of two towards an automatic rotating tipper. The product is then emptied safely and carefully.

The full layer depalletizer clamp destacks the crates and lays them on a chain conveyor. Its four arms are covered with rubber to adjust the small differences in size of the different crates. The last clamp lateral to grab the crates is divided into three parts to prevent these from falling while they are transported to the chain table.

FEATURES & BENEFITS

- The movements (horizontal and vertical) are controlled by two speed variators for a smooth operation of the machine.
- The pallet entry is by two chain conveyors that advance the pallets and put them in the correct place for de-stacking.
- The empty pallet evacuation can be done by transfer or by conveyor, grouping them in a pallet stacker to facilitate their evacuation.
- Highest quality standards to ensure long durability.



3 crate depalletizer-tipper in a citrus packhouse

KEY SPECIFICATIONS

- Designed to comply with the Machine Directive of the European Union (CE) 2006/42/CE

- Maximum capacity:
Standard- 1440 crates/hour
Delicate fruit- 1200 crates/hour

TECHNICAL INFORMATION

- Power: 3 phases - 400 V - 50 Hz

- Power consumption: 9,32 kw (including pallet stacker)

- Air consumption: 62,72 liters/min

- Designed with mechanical fencing system and electronic safety according to CE regulations.

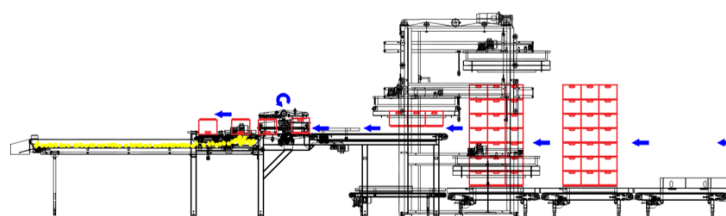

Use diagram for the 6 boxes depalletizer-tipper

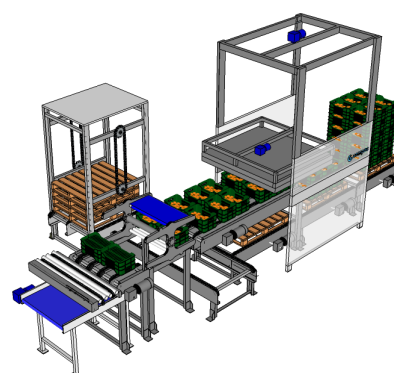

3D scheme for the 6 boxes depalletizer-tipper