



Flag distributor to 3 different lines



## Flag distributor

Machine designed for a smooth fruit transfer, with a 90° change of direction allowing multiple combinations in the product distribution. The operation principle consists of PVC flaps that move along the lanes on top of the machine, pulled by rods that are dragged by chains. In each of the outlets there is a set of sliding doors, which may be in the closed or open position. Under the doors there are conveyors that evacuate the fruit to the next section of the installation.

### FEATURES & BENEFITS

- By opening and closing the flap doors in the different lanes and outlets, multiple combinations can be obtained in the fruit distribution. The flap doors corresponding to the last outlets are always open, for the surplus collection.
- Possibility of opening and closing the flap doors manually or pneumatically (on request)
- Highest quality standards to ensure long durability.



Flag distributor in a citrus packhouse

## KEY SPECIFICATIONS

- Designed to comply with the Machine Directive of the European Union (CE) 2006/42/CE
- Maximum capacity: consult each case.
- Number of lanes availables: 2 - 10
- Lane spacing available (mm):  
250 / 280 / 300 / 320 / 400

## TECHNICAL INFORMATION

- Power: 3 phases - 380 V - 50 Hz
- Power consumption: consult.
- Air consumption: consult.

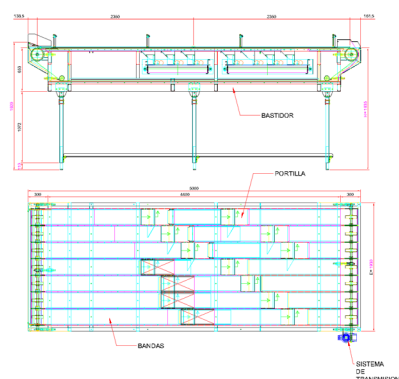

Plant and side view for a flag distributor.